



**APPLICATION**

The round canopy luminaire provides a wide and even symmetrical light distribution. Use for safety or security location of parking areas, walkways and underpasses.

**FEATURES:**

- Rugged die-cast aluminum housing and injection molded high impact UV stabilized clear prismatic polycarbonate lens.
- Die-cast aluminum housing with a dark bronze polyester powder coated finish, available in white or black finish.
- Housing with 1/2" side hub and plug provided. (Field installation of button photocell not included)
- Housing has silicone gaskets to secure the seal between the lenses and the housing.
- Available with tamper resistant screw as option.

**MOUNTING:**

- Ceiling or surface mount.
- Direct mounting to recessed J-box or 1/2" threaded plugs for conduit entry.

**LENS:**

- Injection molded high impact UV stabilized prismatic polycarbonate lens.
- Polycarbonate lenses will protect the light source against abuse, such as severe impact and vandalism.

**LAMP:**

- HID lamps will have medium base (E26 BD/ED17) porcelain socket with screw shell and center contact.
- Compact fluorescent lamp, 4-pin, single or double lamp option available.
- Lamp included.

**ELECTRICAL:**

- MH ballasts are standard high power factor ballast with ambient operating temperature of -20°F (-30°C) to 108°F (90°C); 180°C insulation system.
- HPS ballasts are standard high power factor ballast with ambient operating temperature of -40°F (-40°C); 180°C insulation system.
- The compact fluorescent lamps use a multi-voltage (120-277V) electronic high power factor ballast.

**LISTING:**

- UL/CUL listed.
- Suitable for wet location.
- ARRA compliant (optional).

**DISCONTINUED**

**CRDL1  
CRDL2**

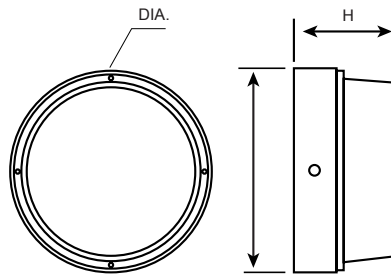

**Specifications: CRDL1**

Height: 7-7/16 (189)  
Diameter: 11-13/32 (290)

**Specifications: CRDL2**

Height: 7-7/8 (200)  
Diameter: 15 (380)

All dimensions are in inches (millimeters).

CONFIGURATIONS	
CRDL1	(1 or 2) CF13, (1 or 2) CF18, (1 or 2) CF26, (1 or 2) CF32, (1 or 2) CF42, M35, M50, M70, H35, H50, H70
CRDL2	(1 or 2) CF13, (1 or 2) CF18, (1 or 2) CF26, (1 or 2) CF32, (1 or 2) CF42, M35, M50, M70, M100, M150, M175, H35, H50, H70, H100, H150

**ORDERING INFORMATION**

EXAMPLE: CRDL2-M175-QT-BZ

MODEL	LAMP TYPE <sup>1</sup>			BALLAST
<b>CRDL1</b> 11-13/32" Dia. Housing	<b>M35</b>	35W Metal Halide <sup>2</sup>	<b>113</b>	<b>(Blank)</b> Standard <b>PS</b> Pulse Start MH <sup>3</sup> <b>SCWA</b> Super CWA Pulse Start Ballast <sup>4</sup>
	<b>M50</b>	50W Metal Halide	<b>213</b>	
	<b>M70</b>	70W Metal Halide	<b>118</b>	
<b>CRDL2</b> 15" Dia. Housing	<b>M100</b>	100W Metal Halide	<b>218</b>	
	<b>M150</b>	150W Metal Halide	<b>126</b>	
	<b>M175</b>	175W Metal Halide	<b>226</b>	
	<b>H35</b>	35W High Pressure Sodium <sup>2</sup>	<b>126T</b>	
	<b>H50</b>	50W High Pressure Sodium <sup>2</sup>	<b>226T</b>	
	<b>H70</b>	70W High Pressure Sodium	<b>132T</b>	
	<b>H100</b>	100W High Pressure Sodium	<b>232T</b>	
	<b>H150</b>	150W High Pressure Sodium	<b>142T</b>	
			<b>242T</b>	
<b>VOLTAGE</b>		<b>FINISH</b>		<b>OPTIONS</b>
<b>120</b>	120V	<b>BZ</b>	Dark Bronze (Std.)	<b>F1</b> Single Fuse (120, 277 or 347V only) <sup>6</sup>
<b>208</b>	208V	<b>WH</b>	White	<b>F2</b> Double Fuse (208, 240 or 480V only) <sup>6</sup>
<b>240</b>	240V	<b>BK</b>	Black	<b>PC1</b> With Photocell - Button Type 120V
<b>277</b>	277V			<b>PC2</b> With Photocell - Button Type 277V
<b>347</b>	347V		Available custom color (RAL) Please provide us with the RAL number.	<b>TR</b> Tamper Resistant Screw
<b>480</b>	480V			<b>EM</b> Emergency Ballast (Only for SQDL2) <sup>7</sup>
<b>QT</b>	120/208/240/277V			<b>ARRA</b> Assembled in USA for Buy American Act
<b>UNV</b>	120-277V <sup>5</sup>			

**NOTES:**

1. See lamp configuration table.
2. 120V only.
3. Pulse Start MH available on 70, 100, 150 and 175 only.
4. Super CWA available on 150 and 175 only.

5. Optional multi-voltage ballast for compact fluorescent.
6. Must specify voltage, not available with 347V and 480V.
7. Only for compact fluorescent unit. (Emergency Ballast options, see page 79).