

SS LED+TW

Project Name:	
Type:	

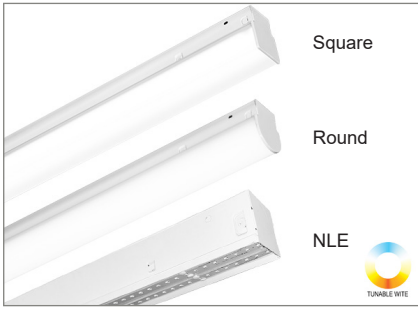

APPLICATION

Tunable White technology can mimic the natural daylight to support Circadian Rhythm - the biological clock, innate in the human body affected by the color temperatures. Ability to adjust color temperature and the light source intensity can enhance synchronization of bodies and minds, essential to ensure maximum productivity during the course of the day. This tunable technologies can provide the ultimate solution to optimize the needs from residential to commercial, healthcare, education, retails, entertainment, office, and more.

FEATURES:

- Die-formed steel channel with knock-outs for versatile configuration and simple mounting.
- Available with 1 or 2 rows of LED, and in single unit lengths or as tandems.
- One continuous lens for 8-foot fixtures.
- Finish is high-gloss baked white enamel over rust inhibiting phosphate coating for maximum corrosion resistance.

MOUNTING:

- Fixture is wall mounted (Not available with sensor option), surface mounted, or suspended mounted with chains, stems or cables.
- Joiner clip provided for easy continuous run (with "CON" option).
- Metal belly band provided to eliminate light leak from space between lenses in continuous run (with "CON" option).
- Compatible with most ceiling types.

LISTING:

- UL/CUL listed and labeled.
- Listed to UL 1598 and UL 8750.
- Suitable for damp locations.
- CEC Compliant EM (please contact for more information)
- ARRA compliant.
- Warranty:
-265K & -275K : 5 years limited warranty.
-3065K : 3 years limited warranty.
Power source: 5 years limited warranty.

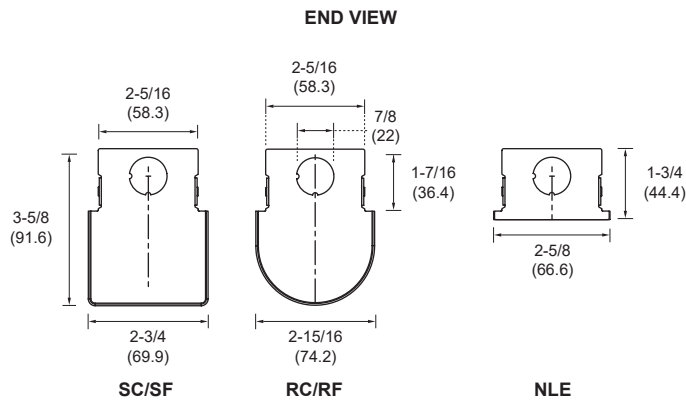

Specifications: SS-2
 Weight: 4.7 lbs (2.13 kg)

Specifications: SS-4
 Weight: 6.9 lbs (3.13 kg)

Specifications: SS-8
 Weight: 10.43 lbs (4.73 kg)

SS LED+TW

ORDERING INFORMATION

EXAMPLE: SS-4-L36-275K-PSQ02U-SF-UNV

MODEL	LENGTH	
SS	2	2' Length ² (Blank) Wiring for Individual mount (Std.)
	3	3' Length
	4	4' Length
	8	8' Length ¹ CON Wiring for Continuous mount (Specify row/length and number of power feed)

* Number of circuit(s) should be determined by the customer prior to ordering the continuous run considering the AC input voltage and total run wattage.

WIRED SOLUTION⁵

LED	SYSTEM	CRI	LED DRIVER
L18 18W LED L27 27W LED L36 36W LED L54 54W LED (N/A 2FT) L72 72W LED (N/A 2&3FT) L108 108W LED (N/A 2&3&4FT) L144 144W LED (N/A 2&3&4FT) <small>* Contact factory for custom wattage or lumen requirement.</small>	-265K Tunable White 2000-6500K -275K Tunable White 2700-5000K -CCK Tunable White custom CCT from 2000-6500K (Must specify the CCT range)	(Blank) 80+ CRI C9 90+ CRI ⁷	ED560 eldoLED LightShape DALI dim to dark, 0.1% ~ 100% MU050 0-10V dual channel, 1% ~ 100% PSQ02U T-Series 1% 2-channel tunable white driver V010V Bridgelux VESTA 0-10V VDALI Bridgelux VESTA Dali2 DT8

CONTROLS	
DUALSWT-WH	2-1 Dual wall switch, 120v only, white finish ⁵ <small>* Only with *MU050* driver.</small>

WIRELESS SOLUTION⁶

LED	SYSTEM	CRI	LED DRIVER	CONTROLS ^{5, 6}
LO Low output, 6 W/ft, 512 lm/ft HO High output, 12 W/ft, 1024 lm/ft <small>* NO custom wattage.</small>	-3065K Tunable White 3000-6500K With wireless solution	(Blank) 90+ CRI ⁷	CV24 24VDC power supply 2DMX 2-channel DMX512 decoder	WL-MZ-WH 4-zone RF remote, white BLT Bluetooth / Smartphone App (Blank) None
L18 18W LED L27 27W LED L36 36W LED L54 54W LED (N/A 2FT) L72 72W LED (N/A 2&3FT) L108 108W LED (N/A 2&3&4FT) L144 144W LED (N/A 2&3&4FT) <small>* Contact factory for custom wattage or lumen requirement.</small>	-265K Tunable White 2000-6500K -275K Tunable White 2700-5000K -CCK Tunable White custom CCT from 2000-6500K (Must specify the CCT range)	(Blank) 80+ CRI C9 90+ CRI ⁷	(Blank) Bridgelux VESTA VWSC Bridgelux VESTA Wisilica Bluetooth VWIZ Bridgelux VESTA WIZ-connected Wi-Fi VSVR Bridgelux VESTA Silvair Bluetooth Mesh VCAS Bridgelux VESTA Casambi Bluetooth Mesh	

DIFFUSER	VOLTAGE	POWER FEED LOCATION	MOUNTING
SC Square - Clear Acrylic Lens SF Square - Frosted Acrylic Lens RC Round - Clear Acrylic Lens RF Round - Frosted Acrylic Lens NLE Non Lens option	UNV 120-277V (Std.) 120 120V 277 277V	PL Power location must be provided in the drawing (Std.) <small>* Required for -CON model only</small>	(Blank) Ceiling Mount VH V-Hook CHxx Chain for use with V-hook (xx=length) ACxx Adjustable Aircraft Cable w/ Canopy (* xx = Specify length (48 or 96)) YCxx Adjustable Aircraft Y-cable with Toggles (* xx = Specify length in inches (60, 120, 180)) SH-3/8-xx 3/8" IPS STEM w/ Canopy SH-1/2-xx 1/2" IPS STEM w/ Canopy (* xx = 18, 24, 36, 48 inches) IDS T-Bar Clip for Surface Mount CD Conduit run

SS LED+TW

FINISH		CORD FINISH		CEILING TYPE		OPTIONS	
(Blank) *BK **CC *AMB	Semi-Glossy White (Std.) Black (RAL#9011) Custom Color ⁴ Anti-Microbial Coating (Matte Skye White) <small>* Non-standard finish with extra charge. ** CC: additional charge & set up fee. Provide RAL# code.</small>	(Blank) BKC	White (Std.) Black <small>* Black cord additional charge.</small>	X1 X2 X3	T-bar ceiling Hard ceiling Sloped Hard Ceiling <small>* Need to be specified for ACxx, SH-3/8-xx, SH-1/2-xx.</small>	EMG5 EMG8 EMG16 ELCU-200 COC SYM ASY JC4	5W EM Battery Backup (CEC Compliant EM) ² 8W EM Battery Backup (CEC Compliant EM) ² 16W EM Battery Backup (CEC Compliant EM) Fail-to-on Emergency lighting, UL924 ³ Separated EM feed for City of Chicago code compliance Symmetric Reflector Asymmetric Reflector 4" Octagon shape junction box cover plate

NOTES:

1. Tandem units.
2. For 2' length, only EMG5 and EMG8 are available.
3. Shipped separately.
4. Refer to color charts (RAL and/or Cardinal) in the separate attachment.
5. Refer to Table #1 to find more information.
6. Refer to Table #2 to find more information.
7. Lumen per watt is approximately 15% less than standard CRI 80+.

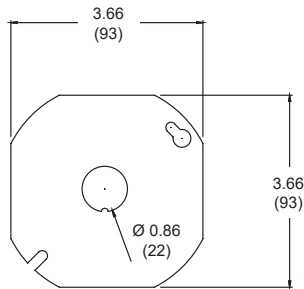

JC4 : Octagon cover plate

SS LED+TW

WIRED SOLUTION (TABLE 1)

SPECIFICATION CHART

	-265K	-275K
Tunable Range	2000 - 6500K	2700 - 5000K
Lumen Efficiency	2500 lm/ft (at 3500K), >115 lm/W	
CRI	80+ (90+ optional)	
Dimming	0.1% - 100%	
Color Consistency	3-step MacAdam binning	
Lumen Maintenance	> 50,000 hours	
Control Options	DALI (#ED560), 0-10V (#MU050), Lutron T-Series (#PSQ02U), V010, VDALI	
Warranty	5 years limited warranty	

COMPATIBLE DIMMER SWITCH CHART

Model #	Brand	Compatible Dimmer Switch	
ED560	eldoLED DUALdrive	<Lunatone>	SS-LUNAT PS2 30mA SS-LUNAT Touch or BT SS-LUNAT Comm
MU050	Moons Intelligent indoor	<Lutron>	Diva - DVTV-xx, DVSTV-xx
PSQ02U	Lutron	<Lutron>	Quantum System Network
V010V	Bridgelux	Industry standard 0-10V dimmer switch	
VDALI	Bridgelux	Industry standard DALI2 DT8 devices	

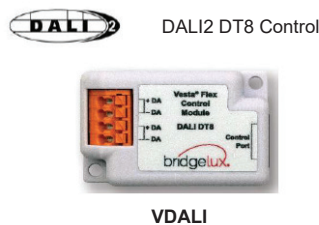
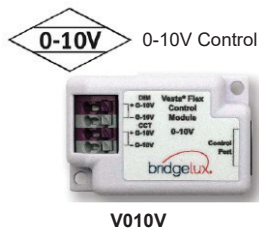

- 0-10V control protocol.
- Two channel control of color temperature and intensity.
- Compatible with industry standard 0-10V current sourcing or 10V current sinking wired control devices

- DALI2 DT8 certified.
- Two channel control of color temperature and intensity.
- Compatible with industry standard DALI2 DT8 devices.
- Commission and manage lighting fixtures via any DALI2 certified controller.

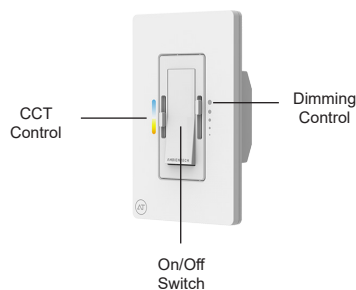

* Wall Plate included

DUALSWT-WH

Input	120VAC, ~60Hz
Max Load	600W
Dimming Curve	Linear, PWM
Compatibility	eldoLED DUALdrive, Moon's 0-10V Dual Series
Features	Field adjustable low-end trim, Built-in Relay
UL listed	UL 1472 / CSA C22.2 184.1
FCC	Class B Part 15



SS LED+TW

WIRELESS SOLUTION (TABLE 2)

	-265K	-275K	-3065K
Tunable Range	2000 - 6500K	2700 - 5000K	3000 - 6500K
Lumen Efficiency	2500 lm/ft (at 3500K), >115 lm/W		512 lm/ft , up to 87.5 lm/W
CRI	80+		90+
Dimming	0.1% - 100%		PWM
Color Consistency	3-step MacAdam binning		-
Lumen Maintenance	> 50,000 hours		> 50,000 hours
Control Options	Bridgelux VESTA Bluetooth Mesh & Wi-Fi. Wisilica, WIZ, Silvoir, Casambi		Wireless remote, Bluetooth (Smartphone / APP)
Warranty	5 years limited warranty		3 years limited warranty

-265K & -275K (CONTROLS)

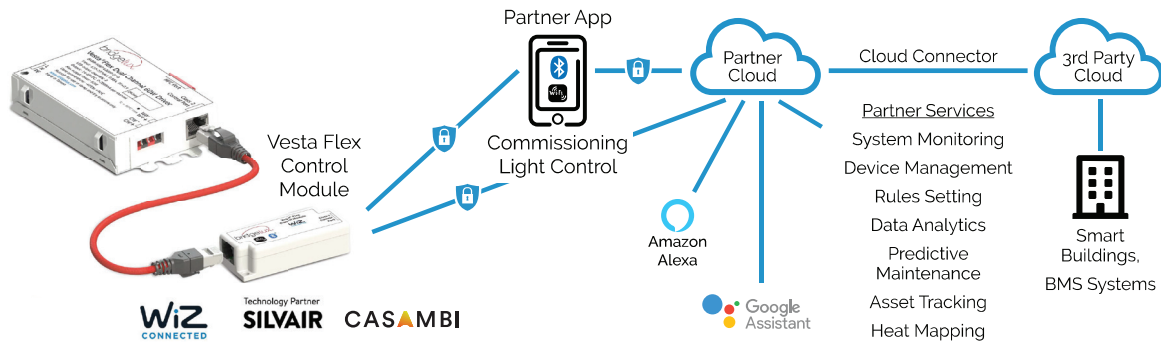

WISILICA BLE Control



VWSC

- Connect lighting fixtures to an intelligent non-flooding BLE mesh network
- Commission and manage lighting fixtures via iOS and Android apps or web portal.
- Interoperates with beacons and sensors via BLE.
- Large ecosystem of compatible sensors, switches, gateways, 3rd party clouds.
- Cloud services such as system monitoring, device management, predictive maintenance, asset tracking, data analytics.



WIZ Wi-Fi Control



VWIZ

- Connect lighting fixture to the internet via Wi-Fi; no hub needed.
- Interoperates with sensors via BLE.
- Commission and manage lighting fixtures via iOS and Android apps or web portal.
- Large ecosystem of compatible sensors, switches, gateways, cloud platform.
- Cloud services such as system monitoring, device management, predictive maintenance, asset tracking, data analytics.



SILVAIR BLE Control



VSVR

- Interoperability with standard BLE mesh lighting ecosystem.
- iOS app and web portal interface options.
- Seamless device commissioning.
- Rules setting and supervision, energy usage monitoring.
- Data gathering on usage, locations, users, time of day.
- Automation based on users and sensors.
- Ecosystem with sensors, switches.
- Firmware updates over the air.
- Customizable and integration-ready APIs.



CASAMBI BLE Control



VCAS

- Casambi proprietary Bluetooth Low Energy mesh protocol.
- iOS app and Android app interface options.
- Seamless device commissioning.
- Rules setting and supervision, predictive maintenance.
- Data gathering on usage, locations, users, time of day.
- Automation based on users and sensors.
- Firmware updates over the air.
- Customizable and integration-ready APIs.
- Ecosystem with sensors and switches, and luminaires.
- Multi level security.



SS LED+TW

-3065K (CONTROLS)



WL-MZ-WH (Wireless Wall remote)

Dimensions	L 4.3" x W 2" x D 0.85"
Weight	0.1 lbs
Signal Type	RF (Radio Frequency) 2.4GHz
Zone	4 zone
Range	98ft from fixture
Working Temp.	-4°F to 131°F (-20°C to 55°C)
* Battery	2 x AAA battery

* Not included.



Smart Life



Tuya Smart

BLT (Bluetooth / Smartphone App)

Bluetooth	
Software	IOS 8.0 and up, Android 4.4 and up
App	Smart Life or Tuya Smart supported
Features	Group, Scences
Bluetooth Distance	> 49ft in open area
Additional Feature	Home Management / Third party control -> Alexa, Google Assistant (by others)

2DMX



2DMX (2-channel DMX decoder)

Dimensions	L 7" x W 1.8" x D 1.2"
Output Current	8A / channel
Input Voltage	12-24V DC
Output Power	384W @ 24V
Frequency	PWM

SS LED+TW

All dimensions are in inches (millimeters).

TOP VIEW

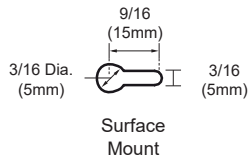
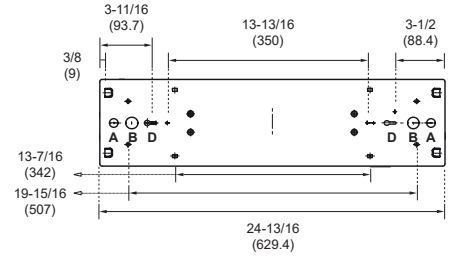

- A : 11/16 (17mm) Dia.
- B : 7/8 (22mm) Dia.
- C : 2 (50mm) Dia.
- D : 3/16 (5mm) Dia.

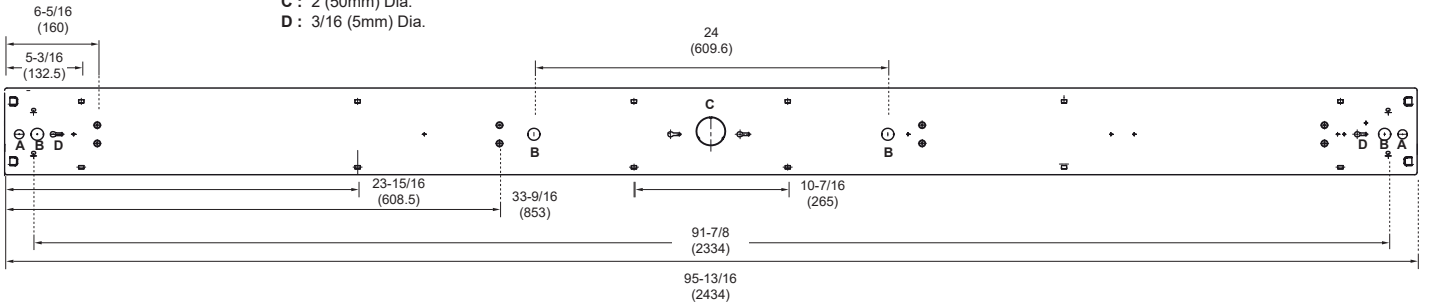
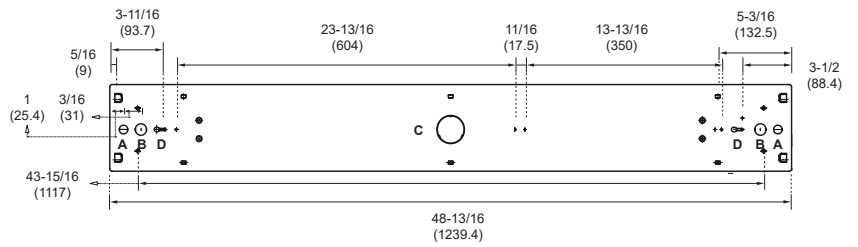

SIDE VIEW

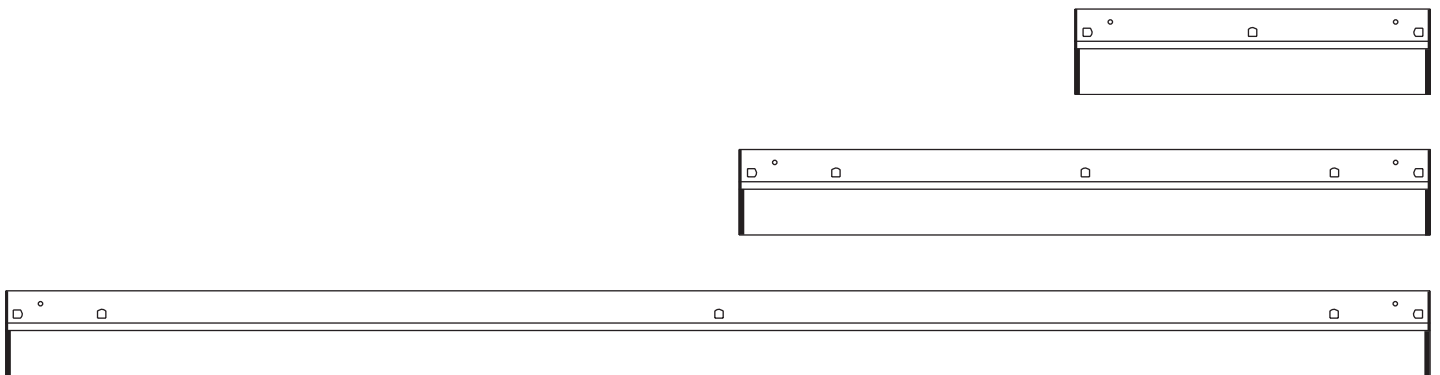

LED TUNABLE WHITE PREMIUM STRIP LIGHT

Mounting Options	Image	Ordering Code
Surface Mount (Ceiling)	<p>Ceiling Junction Box</p> <p>Use keyhole shape mounting holes on the housing</p>	(Blank)
V-hook for Chain Mount	<p>Chain (by others)</p>	VH
Adjustable Cable Mount		ACxx xx = Length of Cable (48 or 96 inches)
Adjustable Aircraft Y-cable with Toggles		YCxx xx = Specify length in inches (60, 120, 180)
Stem Mount (w/ Canopy)		w/ Canopy HOLE A : 3/8" IPS STEM [Example : SH-3/8-xx(length)] HOLE B : 1/2" IPS STEM [Example : SH-1/2!xx(length)] xx = 18, 24, 36, 48 (inches)
T-Bar Surface Mount		IDS

* Cable / Stem mount provided with canopy set

WIRE GUARD

Pentagon : Available with Round/Square Lens options.
Square : Available with Non-Lens option.

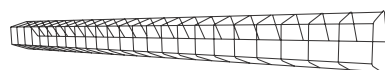

PENTAGON

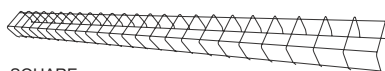

SQUARE

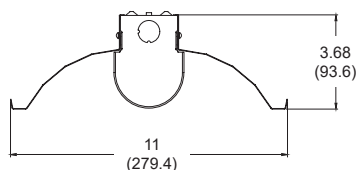

SYM : Symmetric Reflector

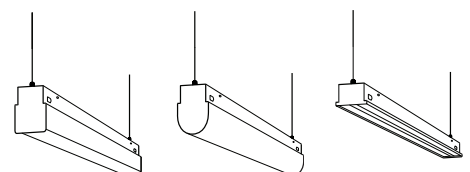

NLE
Non Lens option